

TALL VECTOR™ 74 DIRECT VENT LINEAR GAS APPLIANCE



Specifications: Single-sided

Model	BTU	Width		Height		Depth		Viewing Area
		Actual	Framing	Actual	Framing	Actual	Framing	
TLV74N	48,000	89 5/16	89 13/16	47 15/16	48 3/16	19 7/8	20 1/8	76 9/16 X 26 13/16
TLV74LN								
TLV74P	41,500	89 5/16	89 13/16	47 15/16	48 3/16	19 7/8	20 1/8	
TLV74LP								

Dimensions: Single-sided

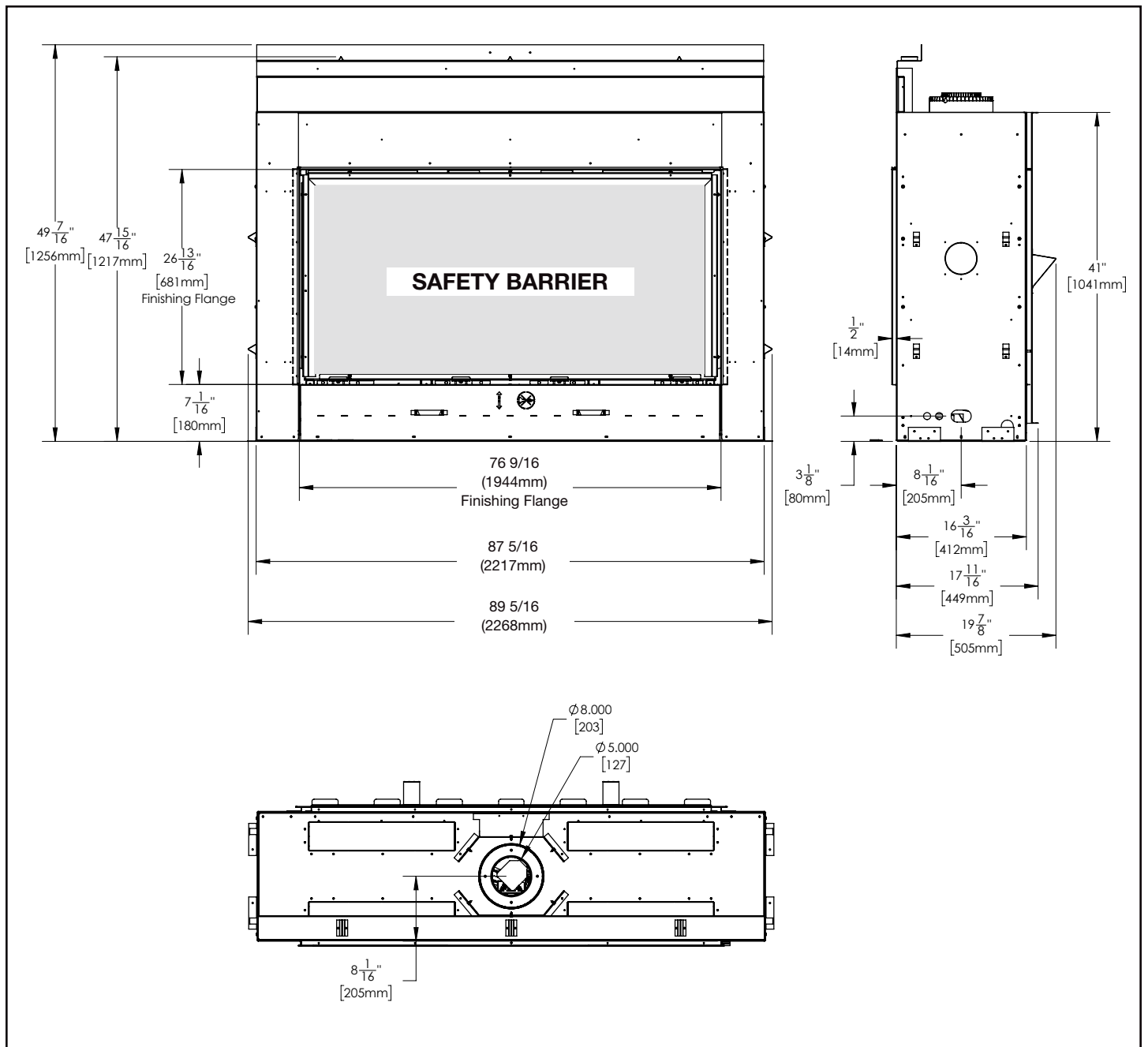

Product information provided is not complete and is subject to change without notice. Please consult the installation manual for the most up to date installation information.

W415-4144 / C-0 / 04.09.24

TALL VECTOR™ 74 DIRECT VENT LINEAR GAS APPLIANCE



Specifications: See-through

Model	BTU	Width		Height		Depth		Viewing Area
		Actual	Framing	Actual	Framing	Actual	Framing	
TLV74N2	48,000	89 5/16	89 13/16	47 15/16	48 3/16	16 3/16	16 3/16	76 9/16 X 26 13/16
TLV74LN2								
TLV74P2	41,500	89 5/16	89 13/16	47 15/16	48 3/16	16 3/16	16 3/16	
TLV74LP2								

Dimensions: See-through

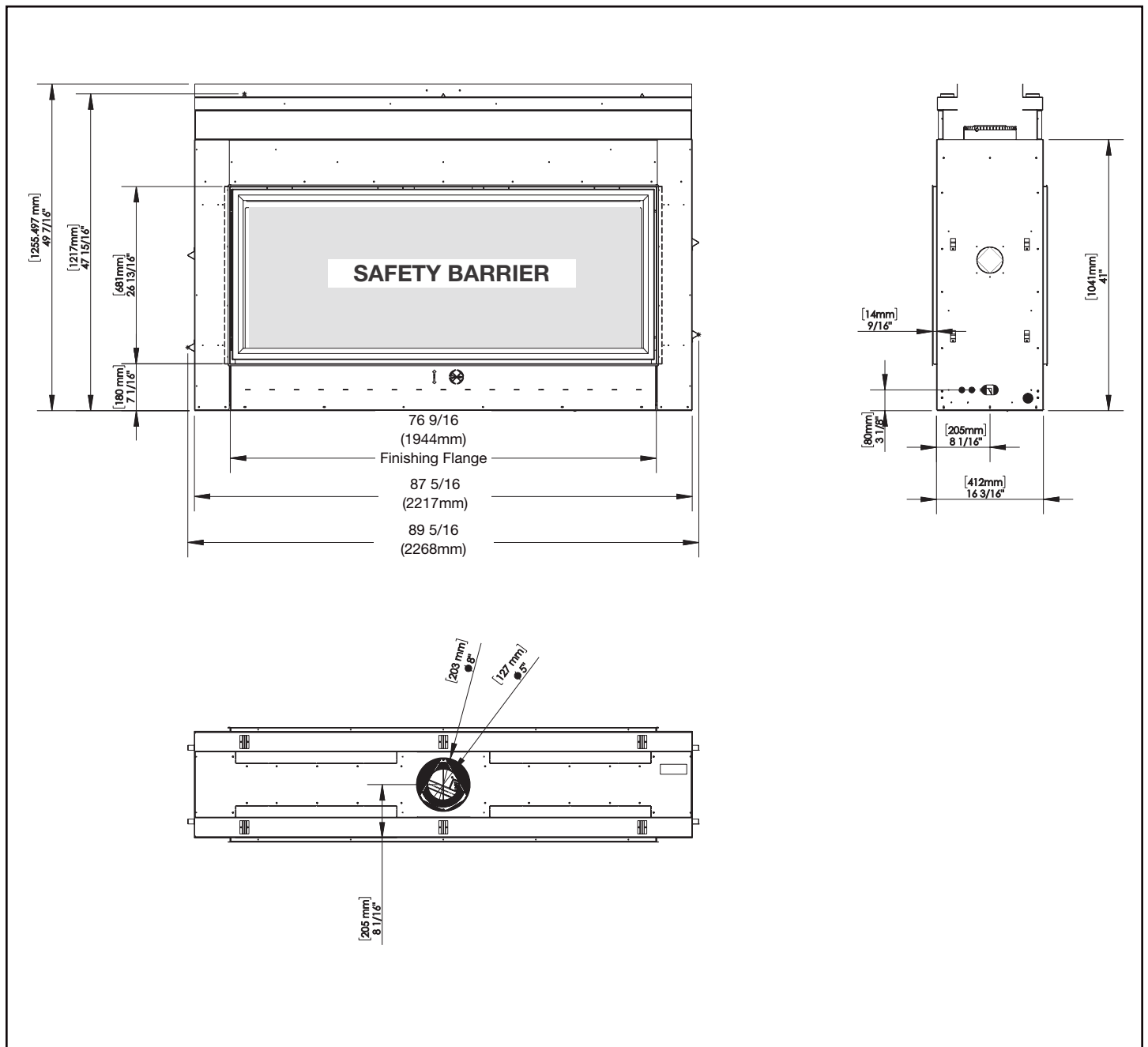

Product information provided is not complete and is subject to change without notice. Please consult the installation manual for the most up to date installation information.

W415-4144 / C-0 / 04.09.24

TALL VECTOR™ 74 DIRECT VENT LINEAR GAS APPLIANCE



Product information provided is not complete and is subject to change without notice. Please consult the installation manual for the most up to date installation information.

Finish Framing

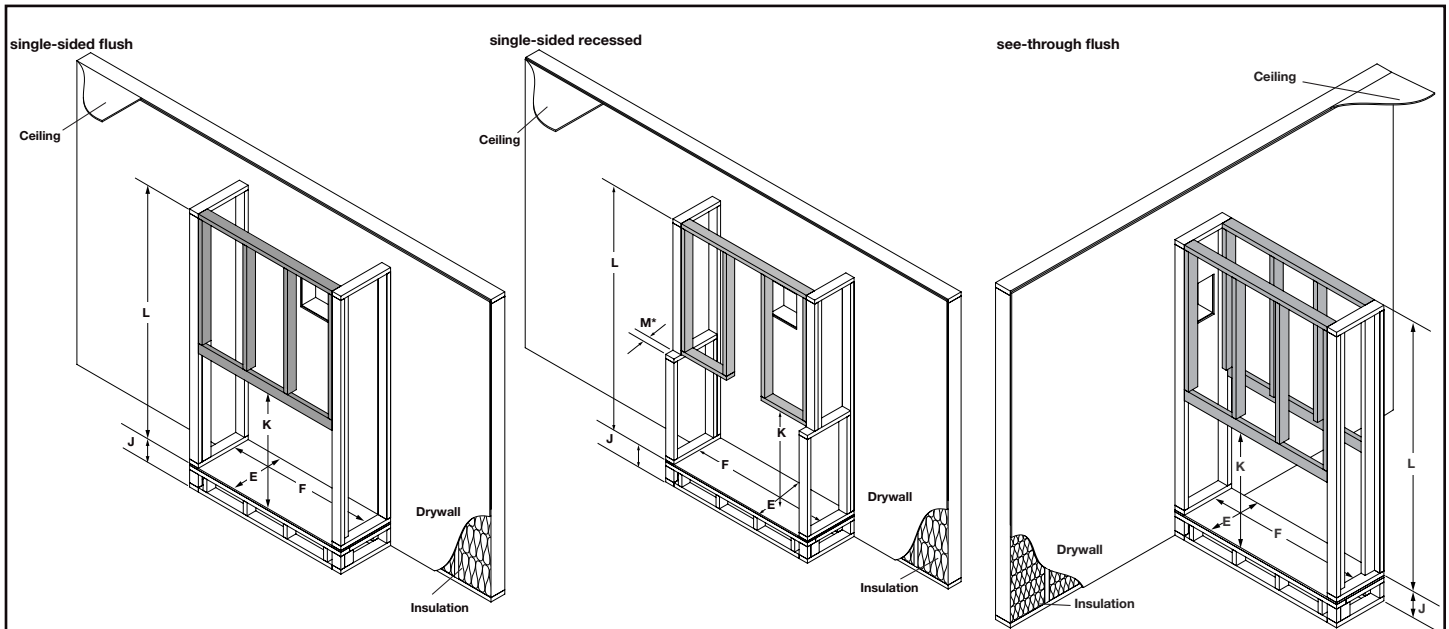

Ref.	TLV74 / TLV74L single-sided
K	48 3/16" (1224mm)
E	20 1/8" (511mm)
F	89 13/16" (2281mm)
J	Optional - Appliance does not need to be elevated above floor.
L	91" (2311mm)
M*	3" (76mm)

*Can only be increased to 4" max by building a protrusion.

Ref.	TLV74_2 / TLV74L2 see-through
K	48 3/16" (1224mm)
E	16 3/16" (411mm)
F	89 13/16" (2281mm)
J	Optional - Appliance does not need to be elevated above floor.
L	91" (2311mm)

note:

The TLV series requires a minimum enclosure/ceiling height, as illustrated (dimension L), measured from the bottom of the appliance. For temperature requirements, this area must be left unobstructed. Some venting configurations that require more vertical rise will require a larger enclosure to provide minimum vertical clearance between vent pipes and combustibles.

Combustible Mantel Clearances

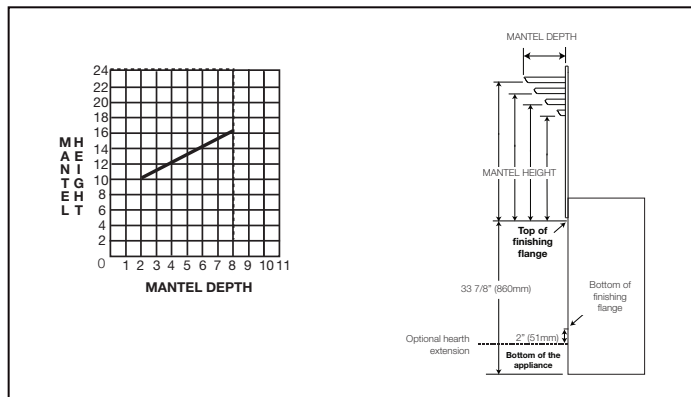

Appliance Location

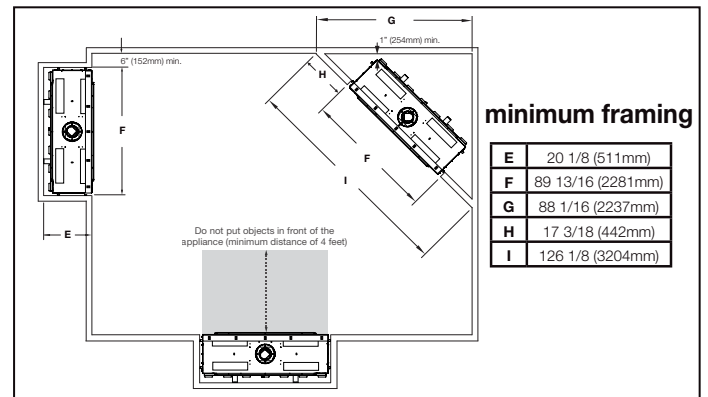

W415-4144 / C-0 / 04.09.24

Spécifications: Simple face

Modèlew	BTU	Largeur		Hauteur		Profondeur		Dimensions de Vision
		Réel	Ossature	Réel	Ossature	Réel	Ossature	
TLV74N	48 000	89 5/16	89 13/16	47 15/16	48 3/16	19 7/8	20 1/8	76 9/16 X 26 13/16
TLV74LN								
TLV74P								
TLV74LP	41 500							

Dimensions: Simple face

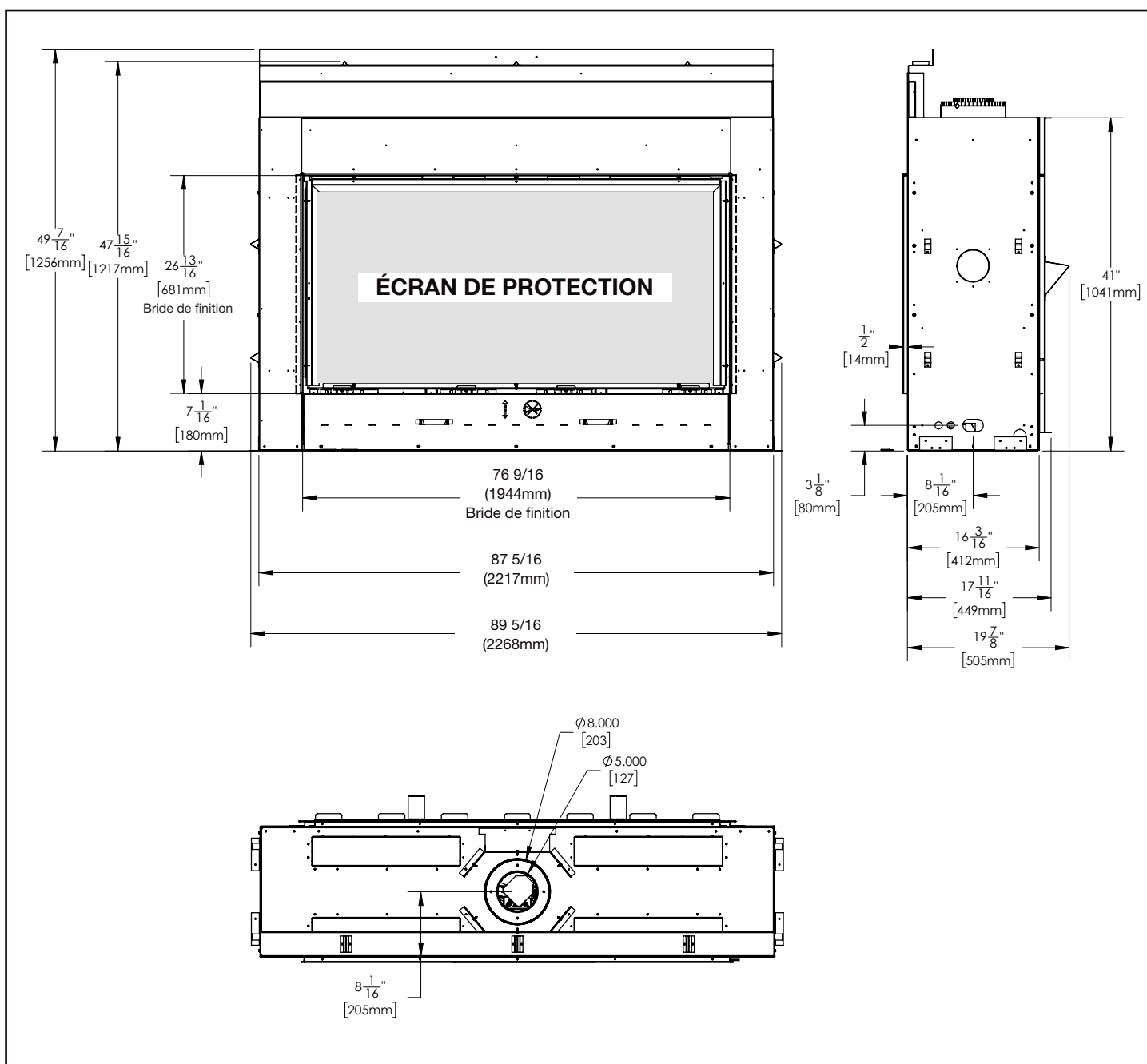

Information du produit fourni n'est pas complet et est sujet de changer sans préavis. Consultez le manuel d'installation pour information d'installation actuel.

W415-4144 / C-0 / 04.09.24

Spécifications: Transparent

Modèlew	BTU	Largeur		Hauteur		Profondeur		Dimensions de Vision
		Réel	Ossature	Réel	Ossature	Réel	Ossature	
TLV74N2	48 000	89 5/16	89 13/16	47 15/16	48 3/16	16 3/16	16 3/16	76 9/16 X 26 13/16
TLV74LN2								
TLV74P2								
TLV74LP2	41 500							

Dimensions: Transparent

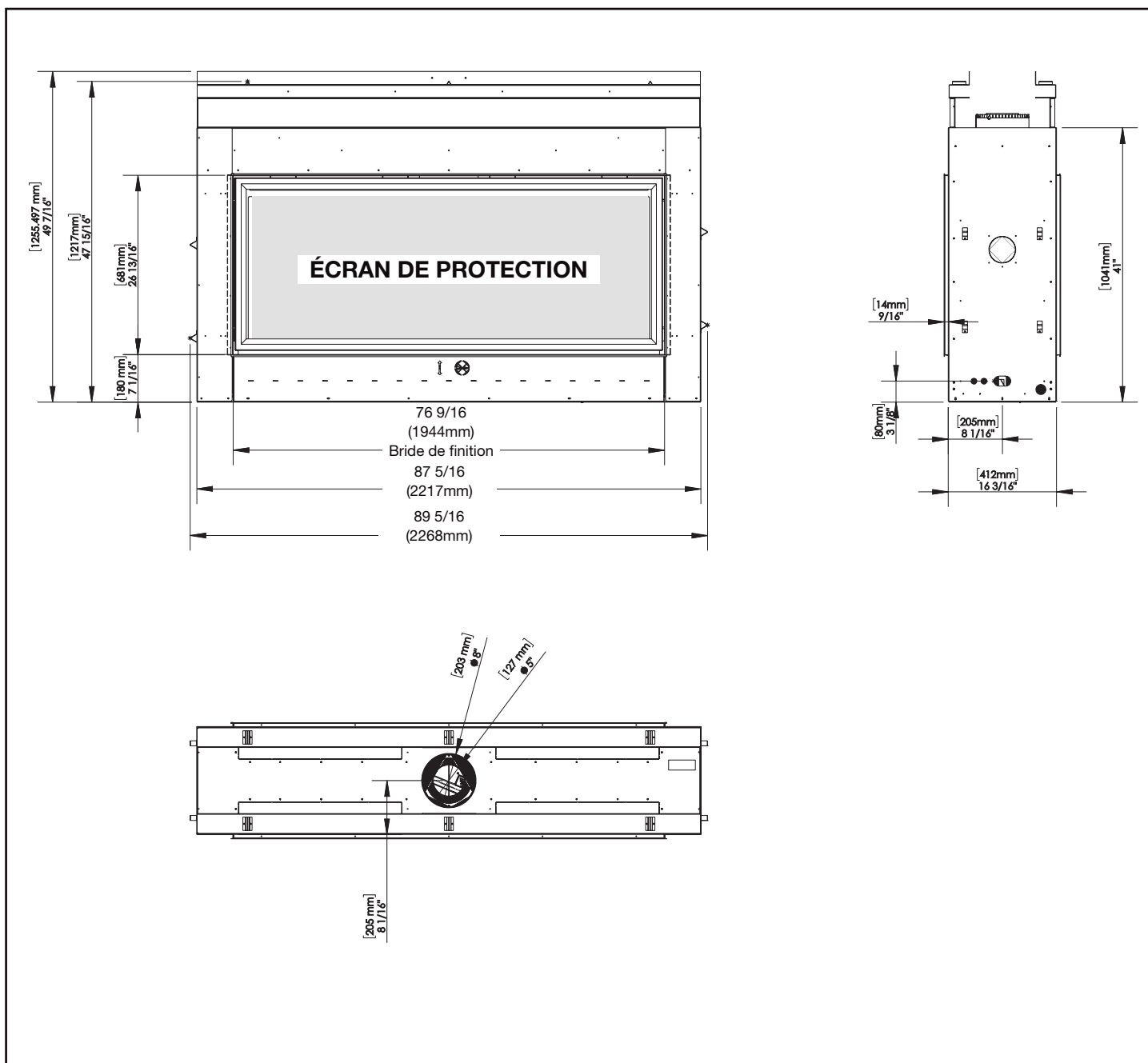

Information du produit fourni n'est pas complet et est sujet de changer sans préavis. Consultez le manuel d'installation pour information d'installation actuel.

W415-4144 / C-0 / 04.09.24

SÉRIE VECTOR^{MD} GRAND 74 FOYER À GAZ D'ÉVACUATION DIRECTE



Information du produit fourni n'est pas complet et est sujet de changer sans préavis. Consultez le manuel d'installation pour information d'installation actuel.

Ossature Finis

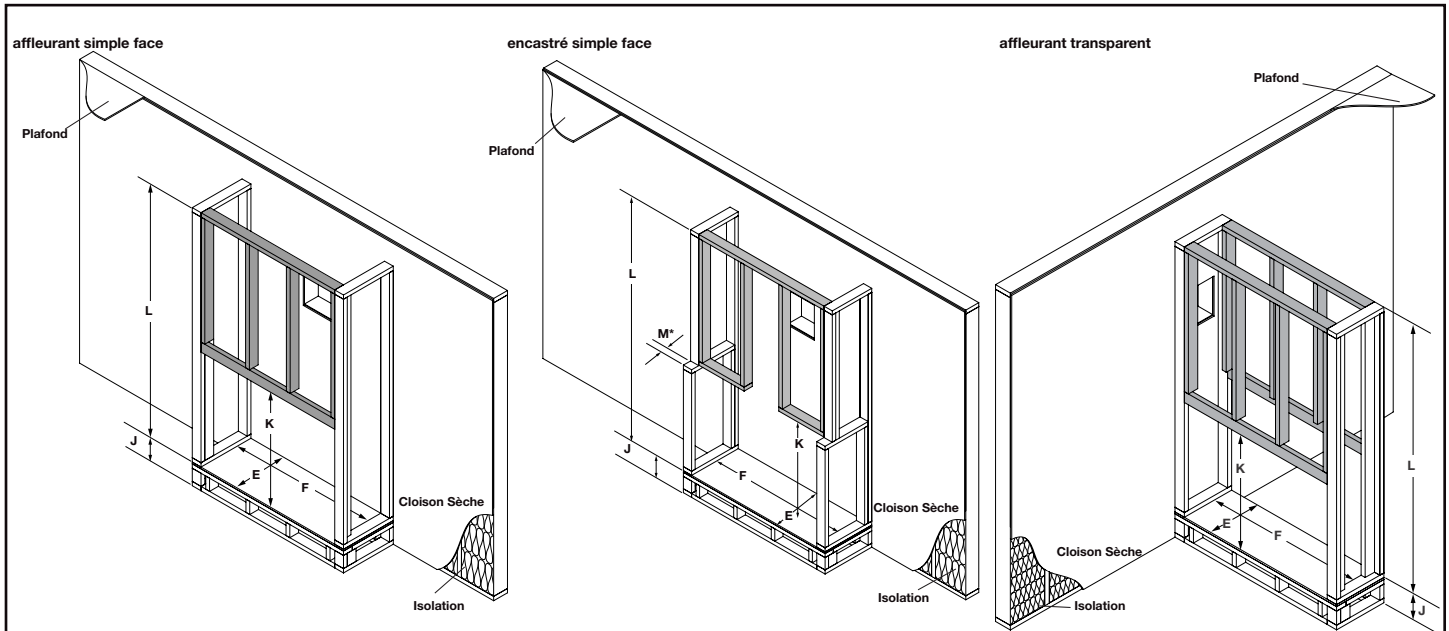

Réf.	TLV74 / TLV74L simple face
K	48 3/16" (1224mm)
E	20 1/8" (511mm)
F	89 13/16" (2281mm)
J	Optionnel - L'appareil ne doit pas être élevé au-dessus du plancher.
L	91" (2311mm)
M*	3" (76mm)

Réf.	TLV74_2 / TLV74L2 transparent
K	48 3/16" (1224mm)
E	16 3/16" (411mm)
F	89 13/16" (2281mm)
J	Optionnel - L'appareil ne doit pas être élevé au-dessus du plancher.
L	91" (2311mm)

*On ne peut augmenter que 4" max en construisant une saillie.

note:

La séries TLV requies un minimum hauteur d'enceinte/plafond, comme illustré (dimension L), mesuré du bas de l'appareil. Pour les exigences de températures, cet espace doit être dégager. Certains configurations qui requies un enceinte plus large pour fournir les dégagements minimaux entre les conduits d'évacuation et les combustibles.

Dimensions Minimales de l'Encadrement

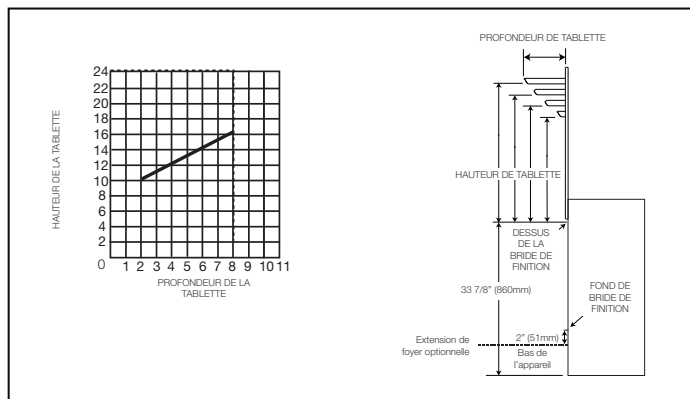

Emplacement de l'Appareil

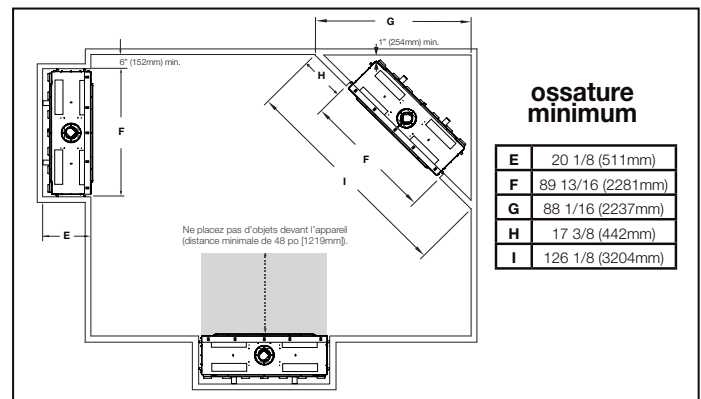

W415-4144 / C-0 / 04.09.24